



A Summary:

COMMUNITY REBUILDING FRAMEWORK

An Urban Management Proposal

Kabul, Afghanistan

Mark D Emmert Eleanor Fawcett Michael Ramage Adriana Rodriguez Lieza H Vincent

MIT-SIGUS Workshop January 2003



OVERVIEW

- **Produce a community-driven model for rebuilding**
- **Establish community resource centers within physical and social framework**
- **Create nucleus for community development and growth**
- **Generate ongoing investment in community**



**Community
Resource
Center**

URBAN SCALE STRATEGY

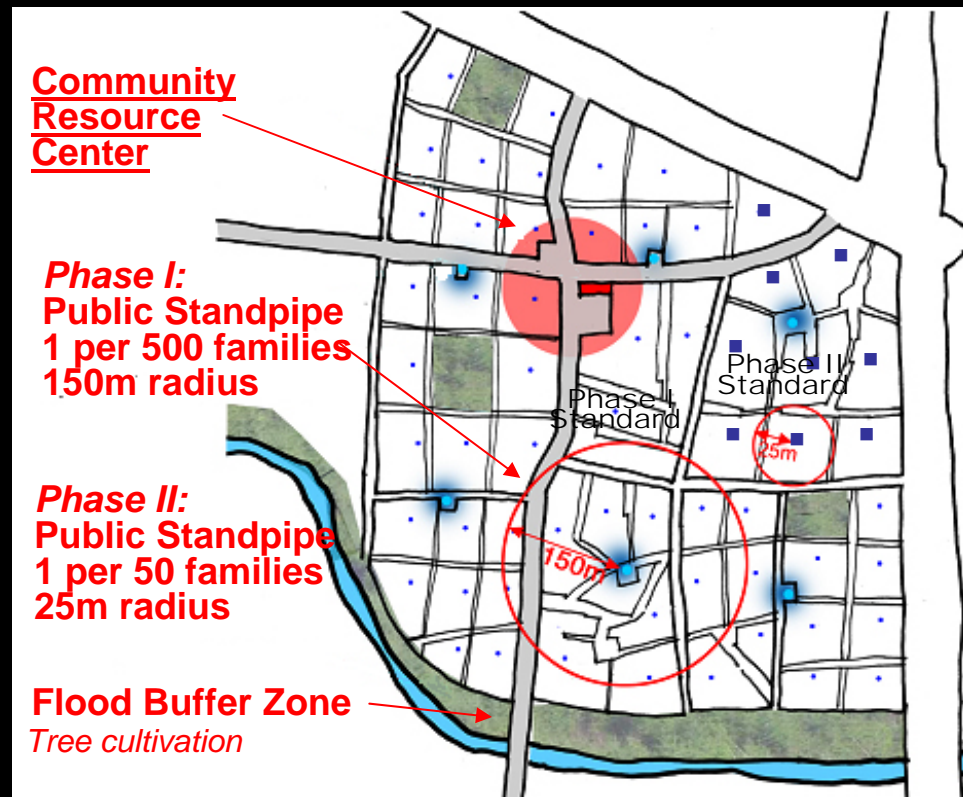
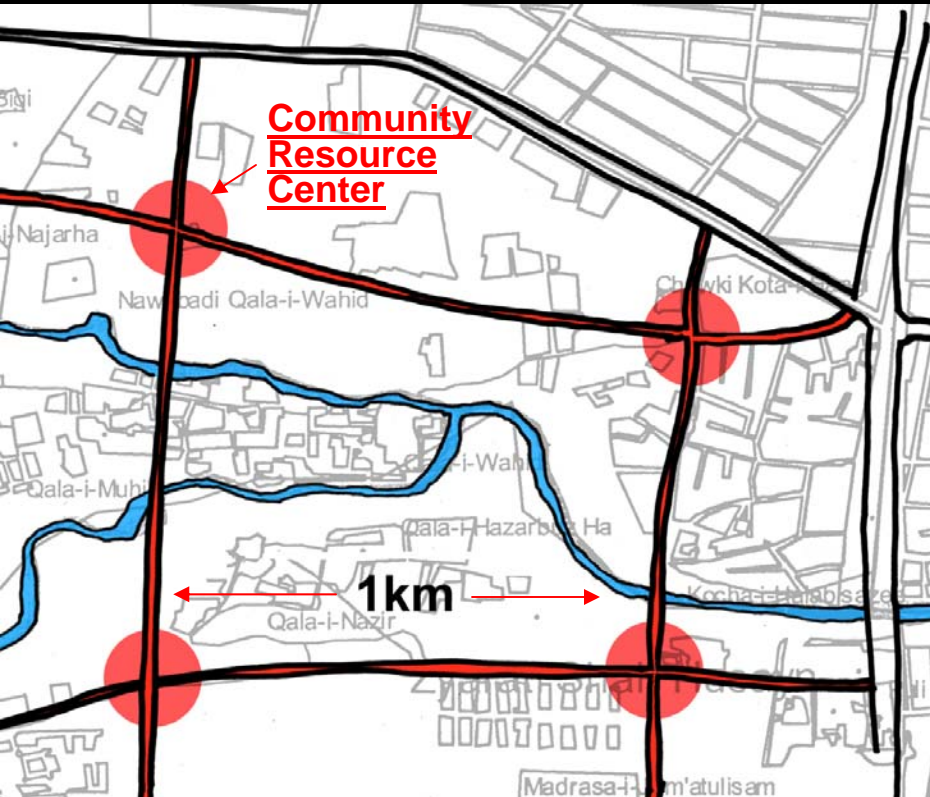

**Street layout provides a structure for development
and a framework for basic water supply**



INFRASTRUCTURE DEVELOPMENT

- **Access to potable water**
Initially standpipes at 150m
Improved to 25m
- **Sanitation infrastructure**
Initially individual pit latrines
- **‘Cash for Trash’ incentive program**

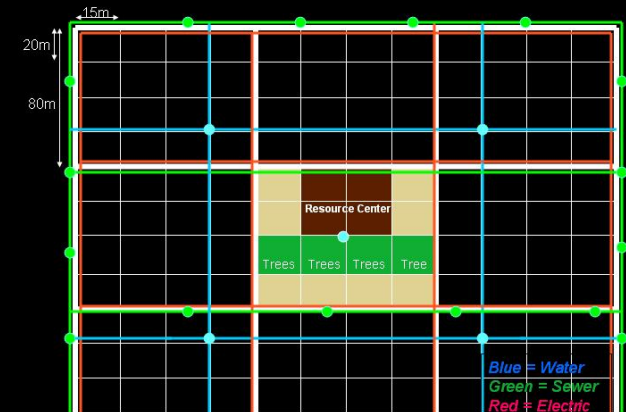



COMMUNITY DEFINITION STRATEGIES

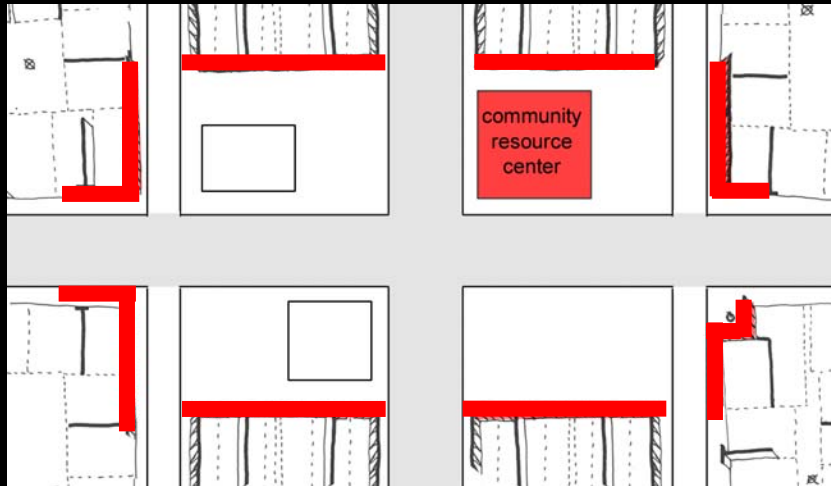

Center of community defined using arcade framework

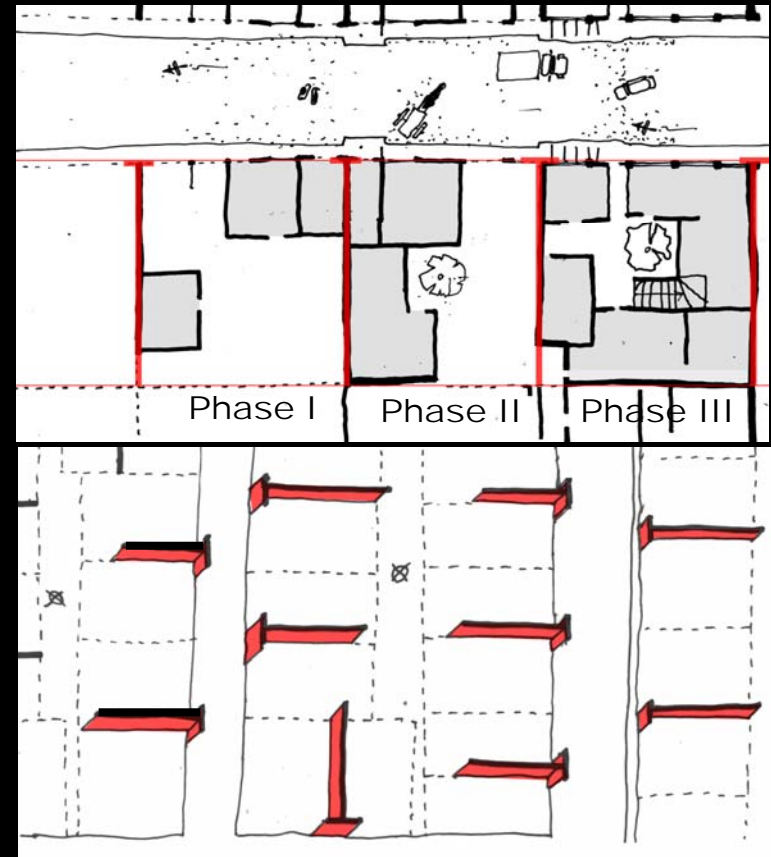

Family houses grow from T-pier stabilized wall



Phase 1: PLANNING – Mobile Truck



ACTIVITIES: survey, layout design, basic water supply, community ‘kick-off’ event

PARTICIPANTS: community, NGO



Phase 2: BUILDING - Semi-permanent Container



ACTIVITIES: clear rubble, construct arcade + T-piers, build resource center, technical support, micro-financing

PARTICIPANTS: community, NGOs, individual families



Phase 3: GROWING - Permanent Community Center



ACTIVITIES: complete resource center, ongoing construction, continued social services

PARTICIPANTS: community, municipality



SUMMARY

- Strategy creates a framework for fostering community ownership of rebuilding process
- Transition from short-term relief to long-term sustainable development
- Resource center responds to community needs

